



Release Notes

Release Date: 29 December 2022

To leave feedback, please email to support@mywave.biz

MYwave takes care to ensure that the information in this document is accurate, but MYwave does not guarantee the accuracy of the information or that use of the information will ensure correct and faultless operation of the service to which it relates. MYwave, its agents and employees, shall not be held liable to or through any user for any loss or damage whatsoever resulting from reliance on the information contained in this document.

Nothing in this document alters the legal obligations, responsibilities or relationship between you and MYwave as set out in the contract existing between us.

Information in this document, including URL and other Internet Web site references, is subject to change without notice.

This document may contain screenshots captured from a standard EMPLX system populated with fictional characters and using licensed personal images. Any resemblance to real people is coincidental and unintended.

Contents

| | |
|---------------------------------------------|----------|
| Release Notes Summary | 1 |
| EmplX Mobile Apps | 2 |
| Overtime Application <i>New</i> | 2 |
| People Finder <i>New</i> | 5 |
| E-Signature for Leave & Overtime <i>New</i> | 6 |
| Updated claim status and payable date | 8 |
| Upcoming maintenance message <i>New</i> | 10 |
| New Language <i>New</i> | 11 |

Release Notes Summary

| Feature | Release Type | Setup Required | User Guide | Contact Support | Admin Access | Supervisor Access | User Access |
|-----------------------------------------------------------------------------------------------------------------------------------------------------------------------------------------------------------------------------------------------------------------------------------------------------------------------------------------------|--------------|----------------|------------|-----------------|--------------|-------------------|-------------|
| EmplX Mobile App (V 3.2.0) <ul style="list-style-type: none"> Overtime <i>New</i> People Finder <i>New</i> E-Signature for Leave & Overtime <i>New</i> Updated Claim Status & Payable Date Upcoming Maintenance Message <i>New</i> New Language Options <i>New</i> | Enhancement | – | √ | – | √ | √ | √ |

EmplX Mobile App

Overtime ^{New}

The latest version of EmplX Mobile App will include **Overtime** application, history, draft and approval. User, Supervisor or HR Admin is now able to submit overtime and view history in the mobile app. Supervisor is also able to approve/reject Overtime items in the mobile app.

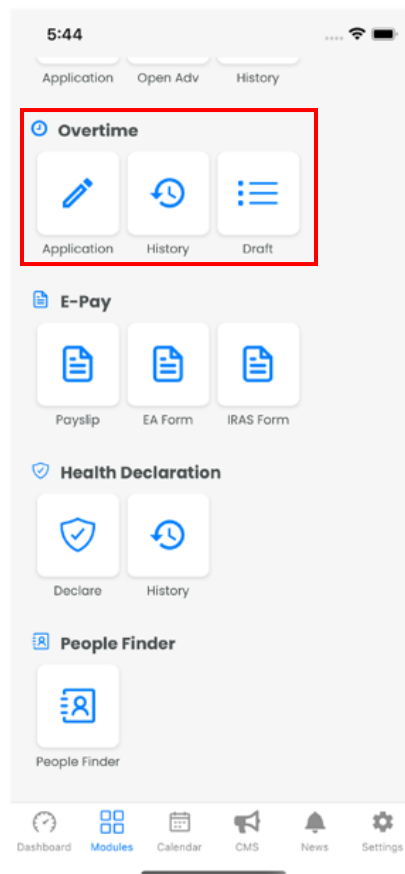

Overtime Application:

Overtime Application

Overtime Type: **OTC** (selected) | **OTP**

Start Date: Select The Start Date

Start Time: Select The Start Time

End Date: Select The End Date

End Time: Select The End Time

Remarks:

Duration: **0day(s) 0hour(s)**

Next

OT Application

Information

Start Date: **2022-12-12**

Start Time: **20:00**

End Date: **2022-12-12**

End Time: **21:00**

Overtime Type: **OTC**

Remarks: **t**

Summary

Compensatory Information

Employee No:

Add to list **Submit**

Overtime History:

OT History

Filters: **All** | **Approved** | **Pending Confirmation** | **Delete**

2022-01-01 Until 2022-12-31

Approved **OTC**

OT ID: **388**

2022-11-23 (16:00:00) Until 2022-11-23 (17:00:00)

Total OT: **0.00 Hour(s)**

Total OT Rate: **0.00 Hour(s)**

Pending Confirmation **OTC**

OT ID: **363**

2022-05-26 (15:00:00) Until 2022-05-26 (16:00:00)

Total OT: **0.50 Hour(s)**

Total OT Rate: **0.50 Hour(s)**

Approved **OTC**

OT ID: **336**

2022-05-11 (18:00:00) Until 2022-05-11 (19:00:00)

Total OT: **1.00 Hour(s)**

Total OT Rate: **3.00 Hour(s)**

OT History Detail

Information

Status: **Pending Confirmation**

OT ID: **363**

Employee:

Shift: **MB12 - 07:00:00 Until 15:00:00**

OT Type: **OTC**

OT Rate: **1**

Total OT: **0.50 Hour(s)**

Total OT Rate: **0.50 Hour(s)**

Remarks: **test**

Overtime Approval:

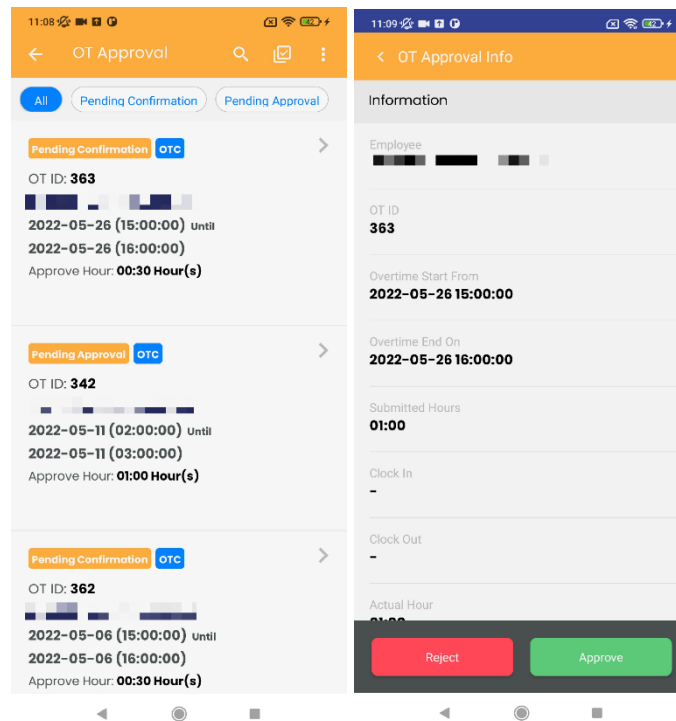

People Finder *New*

People Finder module is now available in EmplX mobile app. User can now call, email, or add to contacts from the People Finder module in the EmplX app.

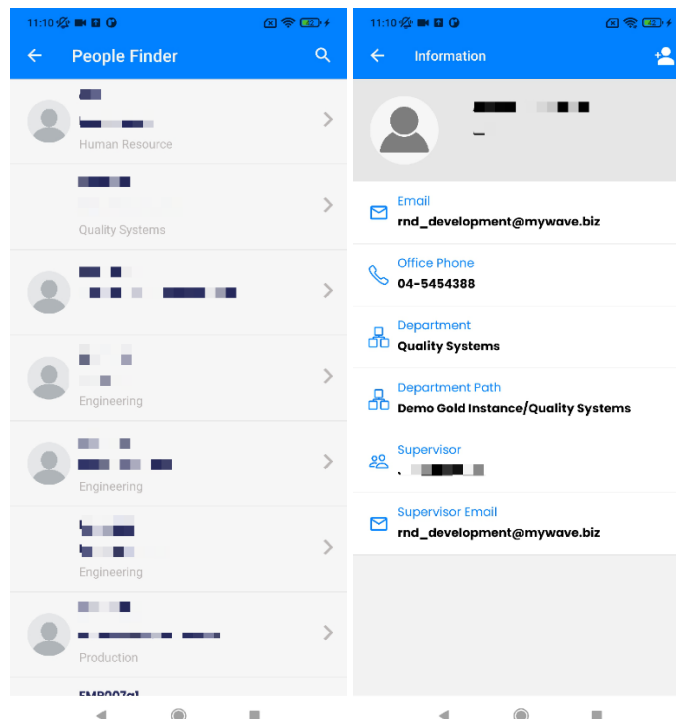
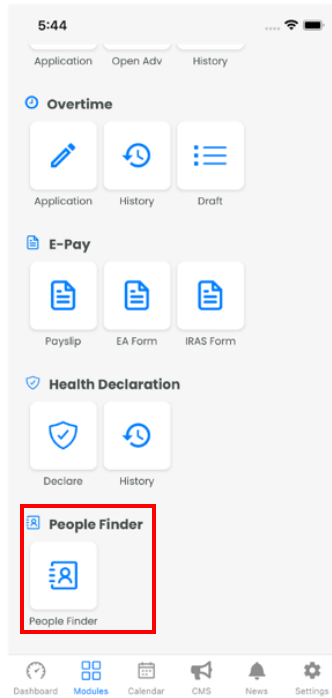

E-Signature for Leave & Overtime New

E-Signature feature is now available in EmplX Mobile for **Leave** and **Overtime** module. Users now have the option to sign when submitting leave or overtime. Supervisors can also sign during leave or overtime approval.

Leave Submission & Approval:

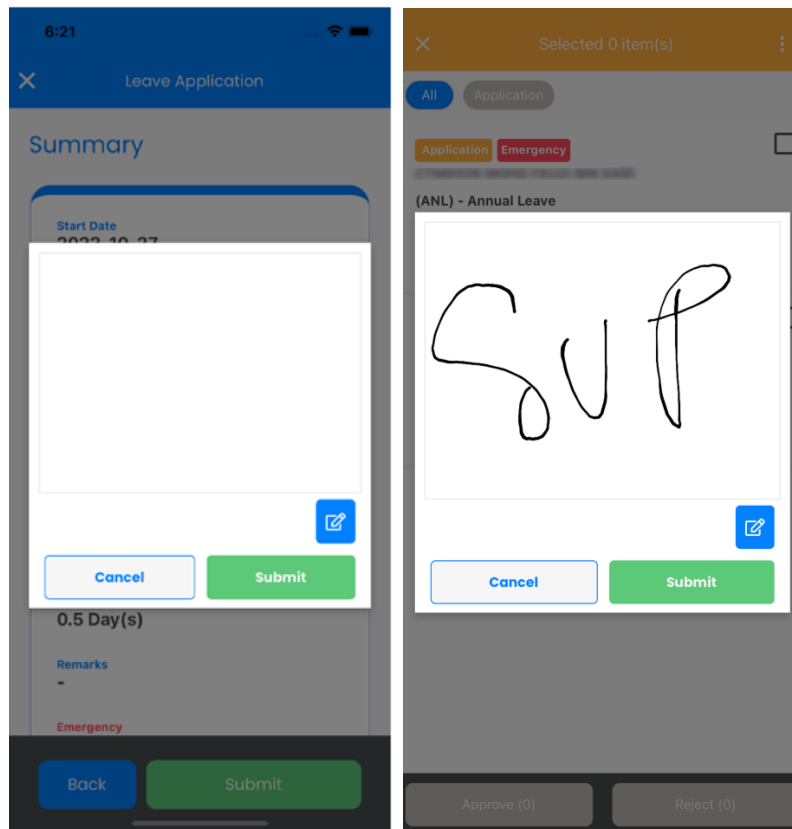

Overtime Submission & Approval:

6:36

< OT Application

Information

Start Date
2022-10-27

Start Time

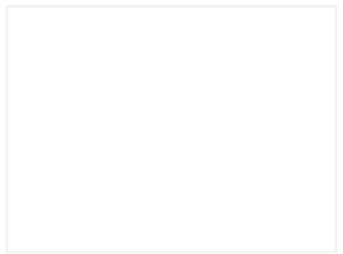



Cancel Submit

Compensatory method
Cash Out

End of Content

Add to list Submit

< OT Approval Info

Information



OT ID

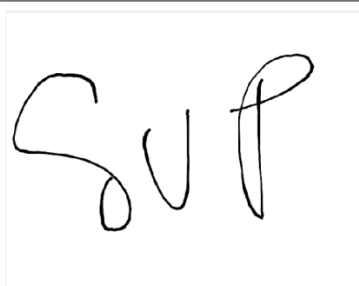



Cancel Submit

Difference (Actual-Submitted)
-

Approved Hour(s)
1:00

Reject Approve

Updated Claim Status & Payable Date

In the latest version of the Mobile App, the claim item count for each status will now be shown in Claim module. Additionally, the **paid date** for claim items with **Paid** status has also been added to Claim History Info in the mobile app.

Before:

Claim module **without** item count and paid date

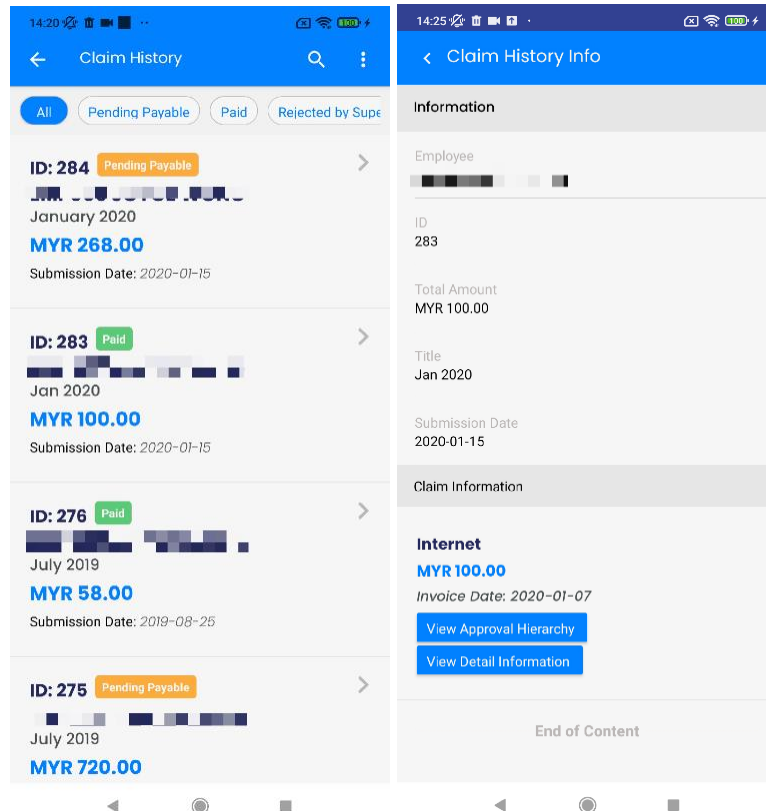

After:

Claim module **with** item count and paid date

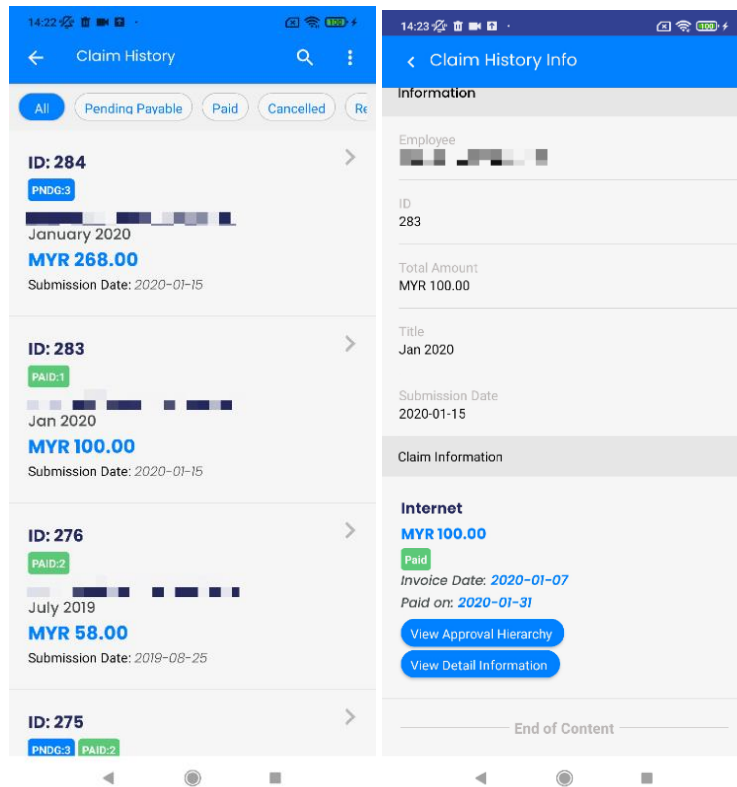

Upcoming Maintenance Message ^{New}

In the latest version of EmplX mobile app, an **Upcoming Maintenance** message has been added to the Login and Dashboard page to inform user of any upcoming maintenance period and that the app will not be accessible during the stated date and time.

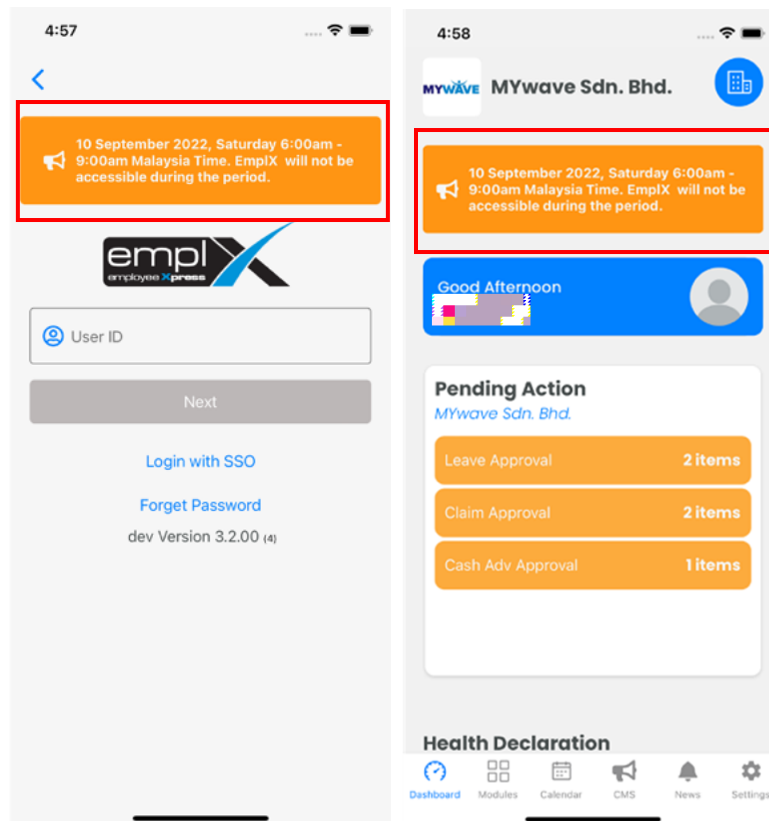

New Language Options New

There are new language options available in EmplX Mobile App. The new languages available in the latest release are listed below

1. Bahasa Indonesia
2. Vietnamese
3. Thai
4. Japanese
5. Nepali

